



27 Compton Street North Lambton NSW

3 1 1

Character filled, circa 1960's clad home in elevated, north facing position in the highly desirable suburb of North Lambton with district views toward Newcastle Harbour. Only minutes drive to shops, cafes, Hospitals, schools, University and short walk to bus stop.

Enter the L-shaped, carpeted lounge and dining room with large picture windows looking out to the front yard and beyond. Many original fixtures remain including colonial ceiling lights and timber veneer wall panels creating a feature wall on point with the current 'v groove' interior trend. Acoustic ceiling tiles assist the reverse cycle air conditioning to insulate.

Walk through the dining area into a galley style kitchen with upcycled cabinet sideboard, electric upright cooker, double

Type : House
Price : \$680,000 to \$720,000
Land Size : 481 sqm
View : <https://www.reecerealty.com.au/sale/nsw/newcastle-region/north-lambton/residential/home/8124548>



Allen Reece
02 4950 2025

[For full version visit the website](https://www.reecerealty.com.au)

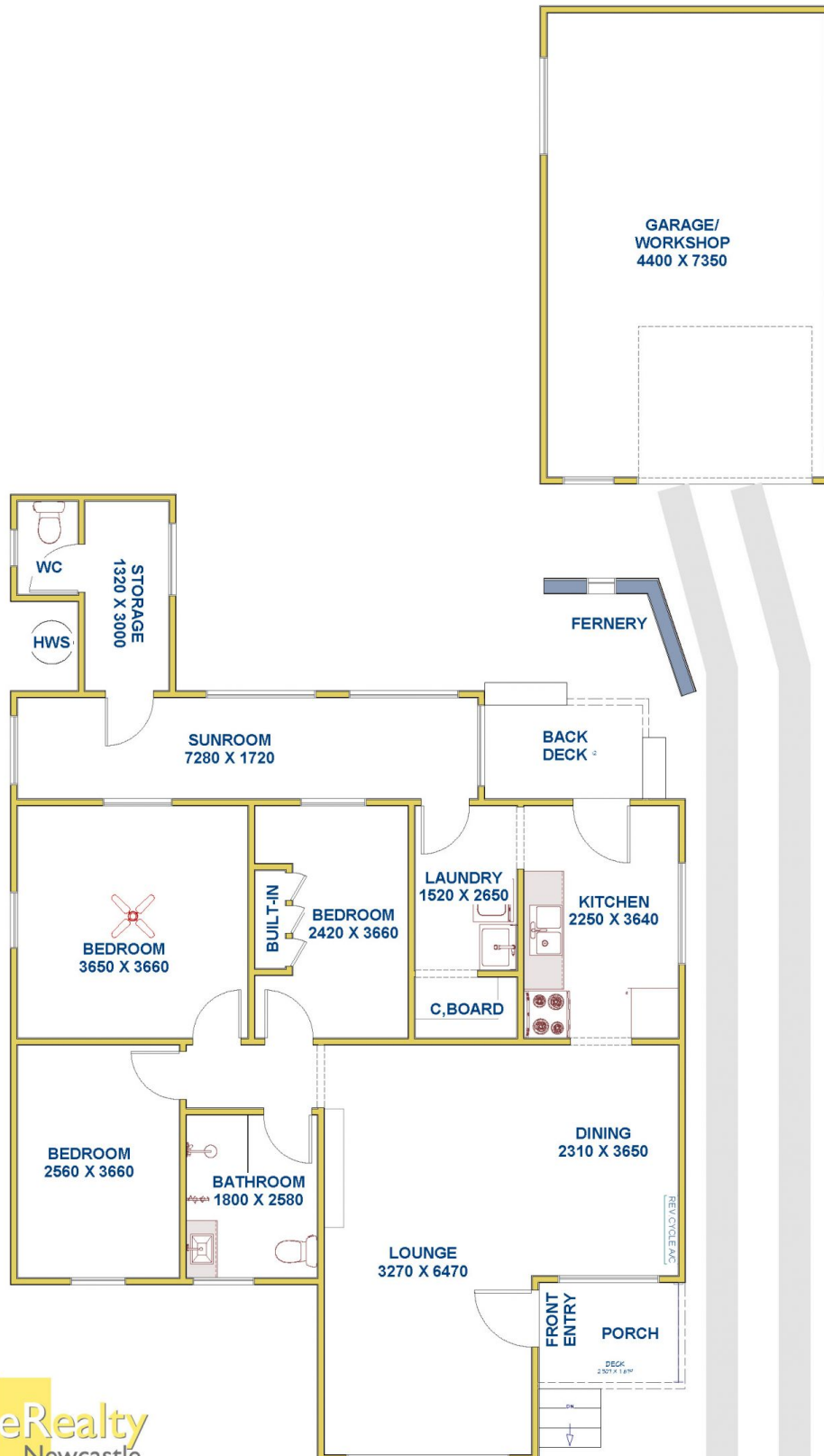

ReeceRealty
Newcastle
and Maitland

Internal Living
Approx. 110m²

**27 Compton Street,
NORTH LAMBTON**

FLOOR DIAGRAM

****NOT TO SCALE****

This drawing has been prepared for marketing
purposes. Dimensions are a guide only.